

NEW!

PROTEKT®

→ AT 241

SELF-CLOSING GATE

TECHNICAL DATA

Material:	stainless steel + powder coated
Weight:	8 kg / 1.200 mm
Dimensions:	1100 x 426 mm

DESCRIPTION

The AT 241 self-closing gate is a functional device enabling safe use of ladders, eg on silos or separating transitions in different locations.

P - Space required for security

L - Length to which the gate should be shortened before assembly (1200 mm length is the standard supplied).

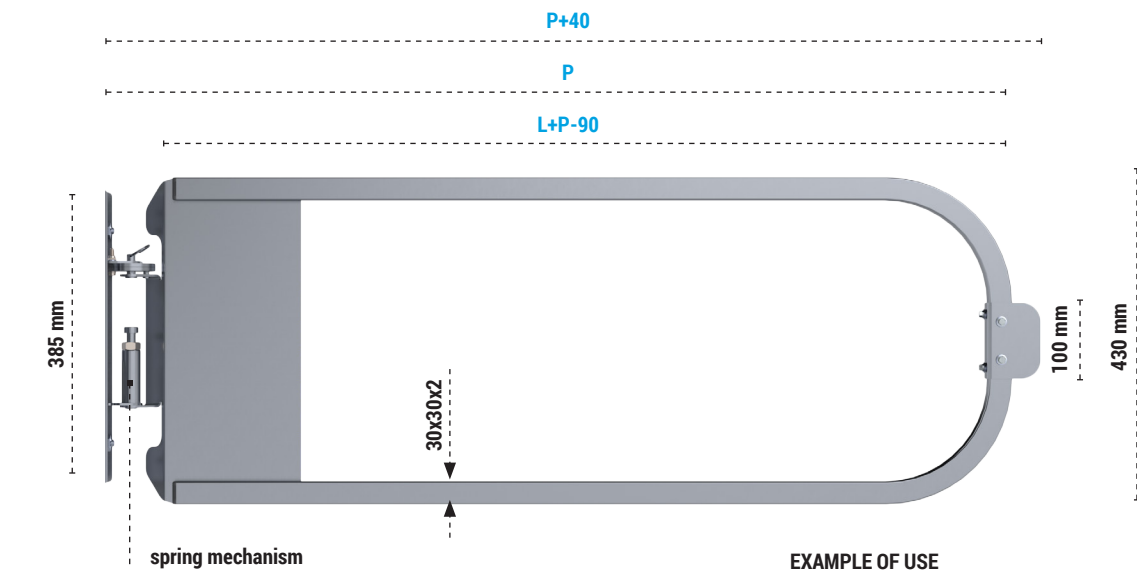

EXAMPLE OF USE



ELEMENTS INCLUDED IN THE SET

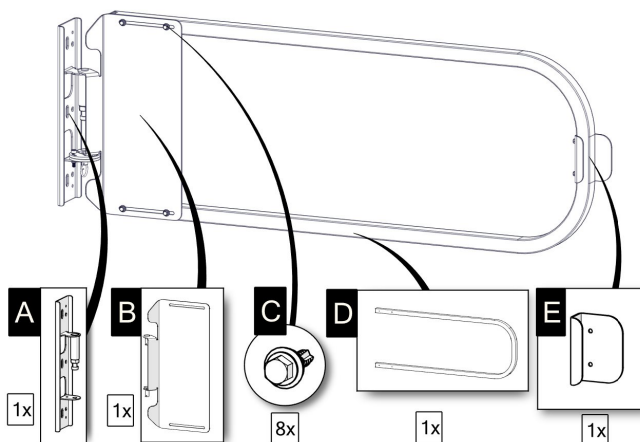

PROTEKT

Starorudzka 9, 93-403 Łódź, tel +48 42 29 29 500, tel +48 42 680 20 83, fax +48 42 680 20 93, email: export@protekt.com.pl

WWW.PROTEKT.COM.PL



AT 241

SELF-CLOSING GATE

NEW!

PROTEKT®

EXAMPLE OF USE OF SELF-CLOSING GATE AT 241

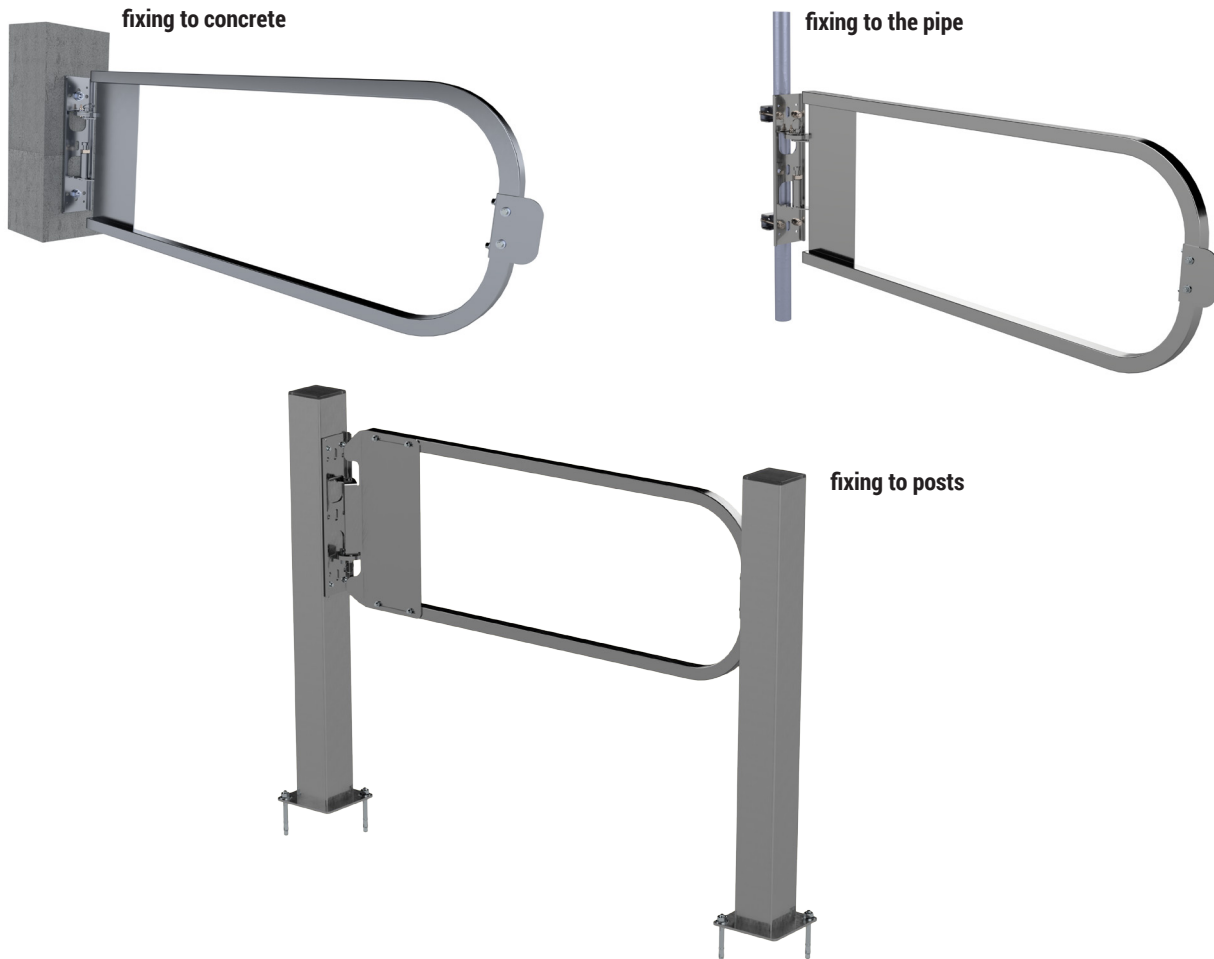

ELEMENTS OF THE SET ARE AVAILABLE SEPARATELY

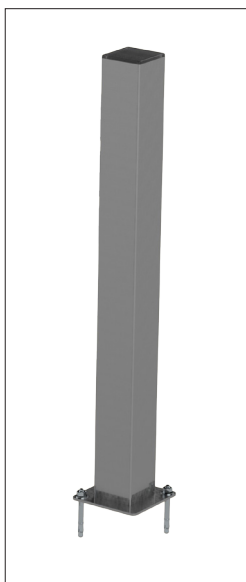

AT241 003
support post

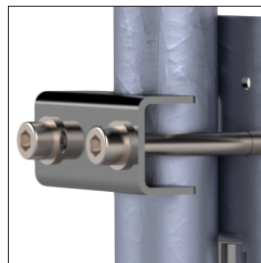

AT241 002
stainless steel clamp
on pipe

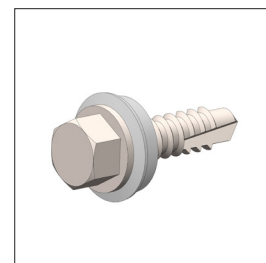

self drilling screws
5 x 25 mm



AT241 004
blocking plate

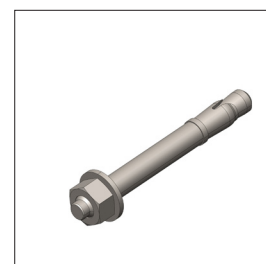

segmented
anchors Hilti
HST2 M12 x 115/20

PROTEKT

Starorudzka 9, 93-403 Łódź, tel +48 42 29 29 500, tel +48 42 680 20 83, fax +48 42 680 20 93, email: export@protekt.com.pl

WWW.PROTEKT.COM.PL